

# Atd-7399 Air Motor Install Instruction for Atd-7390 (5 Ton) & Atd-7391 (10 Ton) Service Jacks

1. Turn release knob counterclockwise, lower saddle to minimum height.
2. Release cover screws, and remove cover, refer to Fig. 1.
3. Remove the air motor port bolt, take care not to damage threads or misplace safety valve cartridge in the process, ensure cartridge is positioned as below, refer to Fig. 2.
4. Install air motor (clockwise to tighten) and torque to 105 Ft. - Lbs., refer to Fig. 3.  
\* **Before install air motor, ensure cartridge in air motor port.**
5. Connect to air supply (90 - 175 PSI), then check for leaks. Retighten as need.

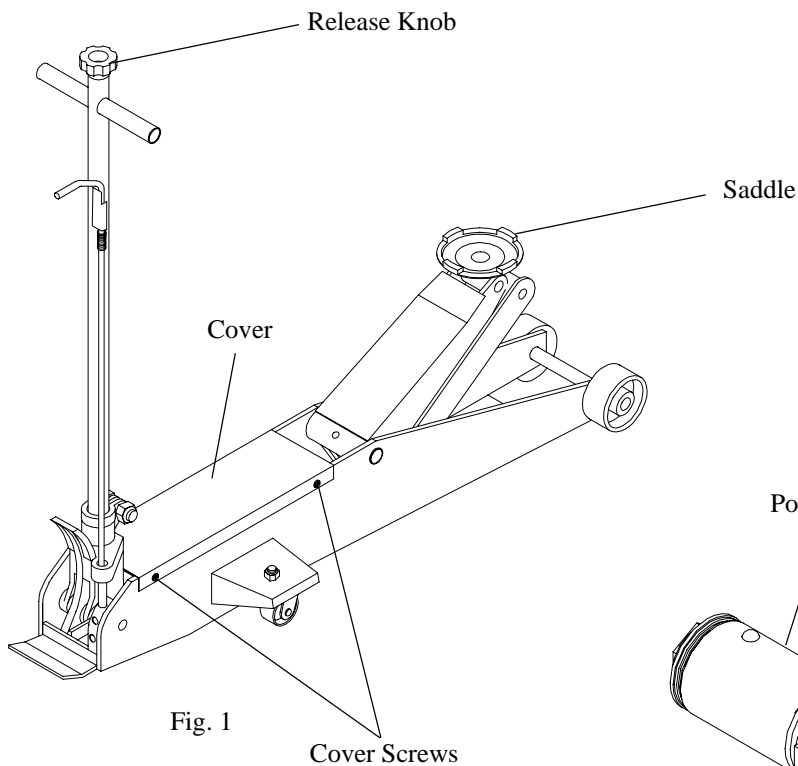

Fig. 1

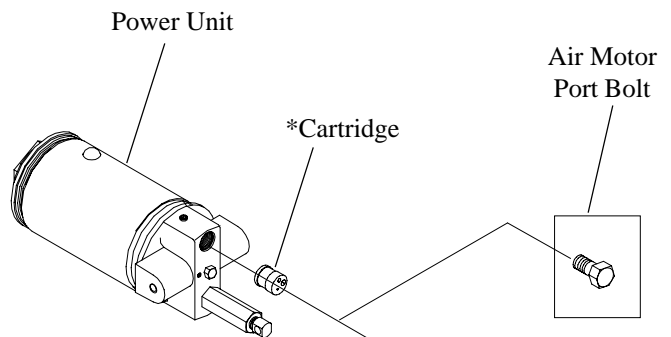

Fig. 2

Torque to :  
105 Ft. - 105 Lbs.

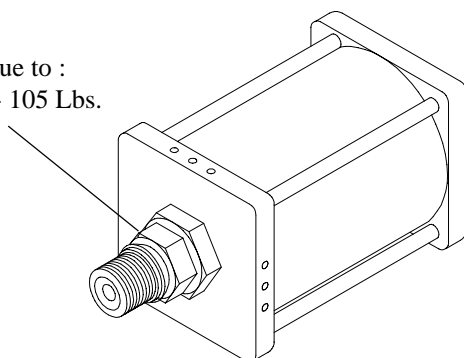
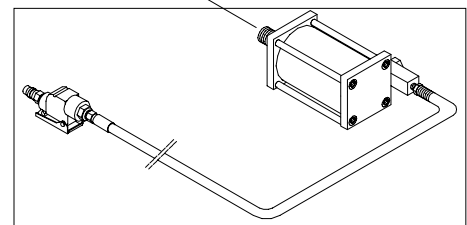

Fig. 3



Air Motor Assy.